

Features

- Rigid poly coated paper cone with rubber surround
- 1-3/8" 2-layer copper voice coil on aluminum former
- Linear Conex spider and strong ferrite motor for controlled motion
- Vented pole piece to reduce compression and increase heat dissipation
- Cosmetic stamped steel frame with low-profile lip no countersinking required
- Frequency response (.frd) and impedance (.zma) text files available
- Same "family look" as the Dayton Audio DVC series subwoofers and passive radiators

Parameters

Impedance (Ω)	8
Re (Ω)	5.6
Le (mH) @ 1 kHz	1.12
Fs (Hz)	40.9
Qms	1.82
Qes	0.37
Qts	0.30
Mms (g)	20.5
Cms (mm/N)	0.74
Sd (cm ²)	128.7
Vd (cm ³)	675.6
BL (Tm)	9.0
VAS (liters)	17.40
XMAX (mm)	5.25
VC Diameter (mm)	35.5
SPL (dB@2.83W/1m)	88.6
RMS Power Handling (w)	70
Usable Frequency Range (Hz)	40 - 4,500

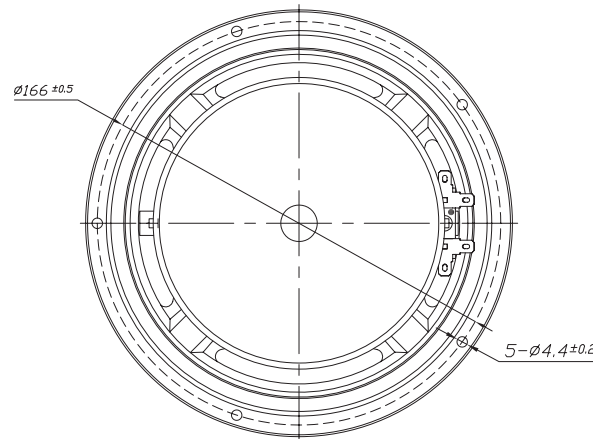
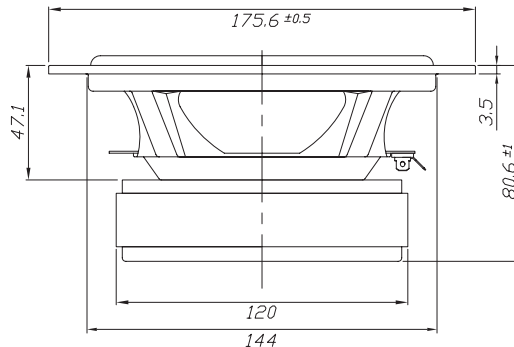

Note: All dimensions in mm.

Frequency Response



Impedance/Phase

