

Features

- Rigid poly coated paper cone with rubber surround
- 1-1/2" 2-layer copper voice coil on aluminum former
- Linear Conex spider and strong ferrite motor for controlled motion
- Vented pole piece to reduce compression and increase heat dissipation
- Cosmetic stamped steel frame with low-profile lip no countersinking required
- Frequency response (.frd) and impedance (.zma) text files available
- Same "family look" as the Dayton Audio DVC series subwoofers and passive radiators

Parameters

Impedance (Ω)	8
Re (Ω)	5.8
Le (mH) @ 1 kHz	1.26
Fs (Hz)	36.7
Qms	1.84
Qes	0.41
Qts	0.34
Mms (g)	30.4
Cms (mm/N)	0.62
Sd (cm ²)	211.2
Vd (cm ³)	1161.8
BL (Tm)	10.0
VAS (liters)	39.2
XMAX (mm)	5.5
VC Diameter (mm)	38.5
SPL (dB@2.83W/1m)	90.1
RMS Power Handling (w)	80
Usable Frequency Range (Hz)	35 - 4,000

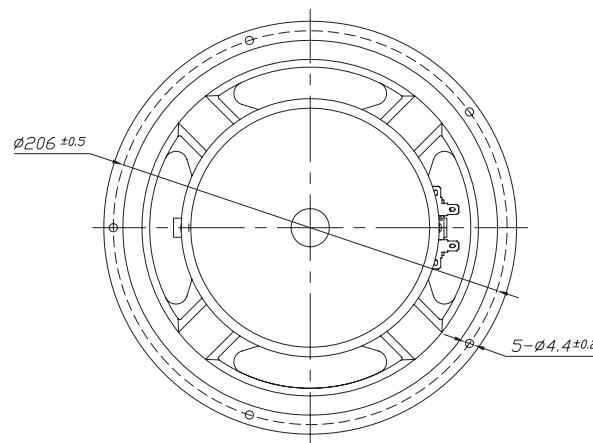
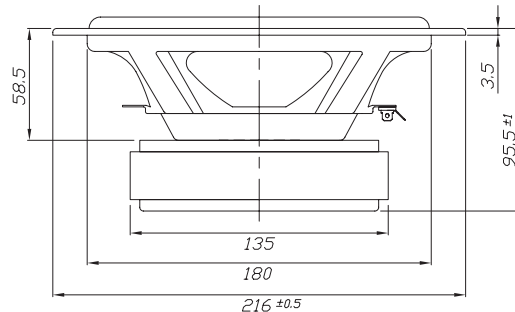

Note: All dimensions in mm.

Frequency Response

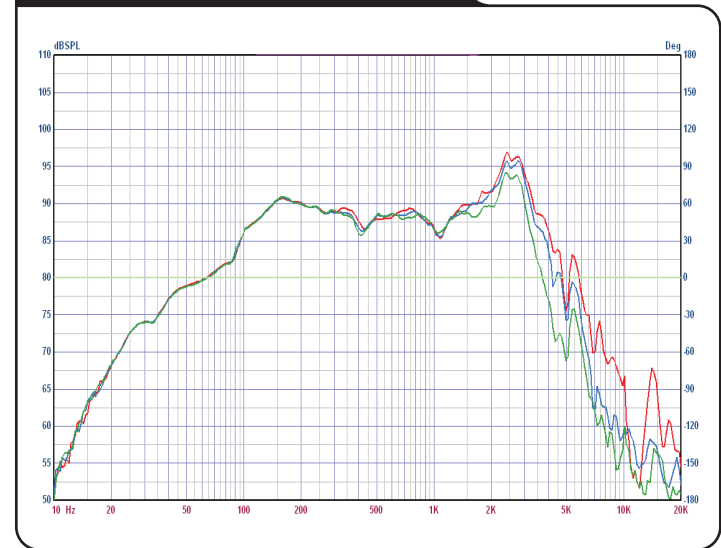

Impedance/Phase

